

(230) – Within the lands zoned RES-4 and shown as affected by this provision on Zoning Grid Schedule 270 of Appendix A, placement or construction of *dwelling*s, sheds, containers, detached garages, *accessory buildings*, indoor pools, outdoor *pools*, and any other *building* or *structure* and storage and parking of vehicles, trailers, and *major recreation equipment* and any other outdoor storage shall not be permitted on lands shown in Figure 1.

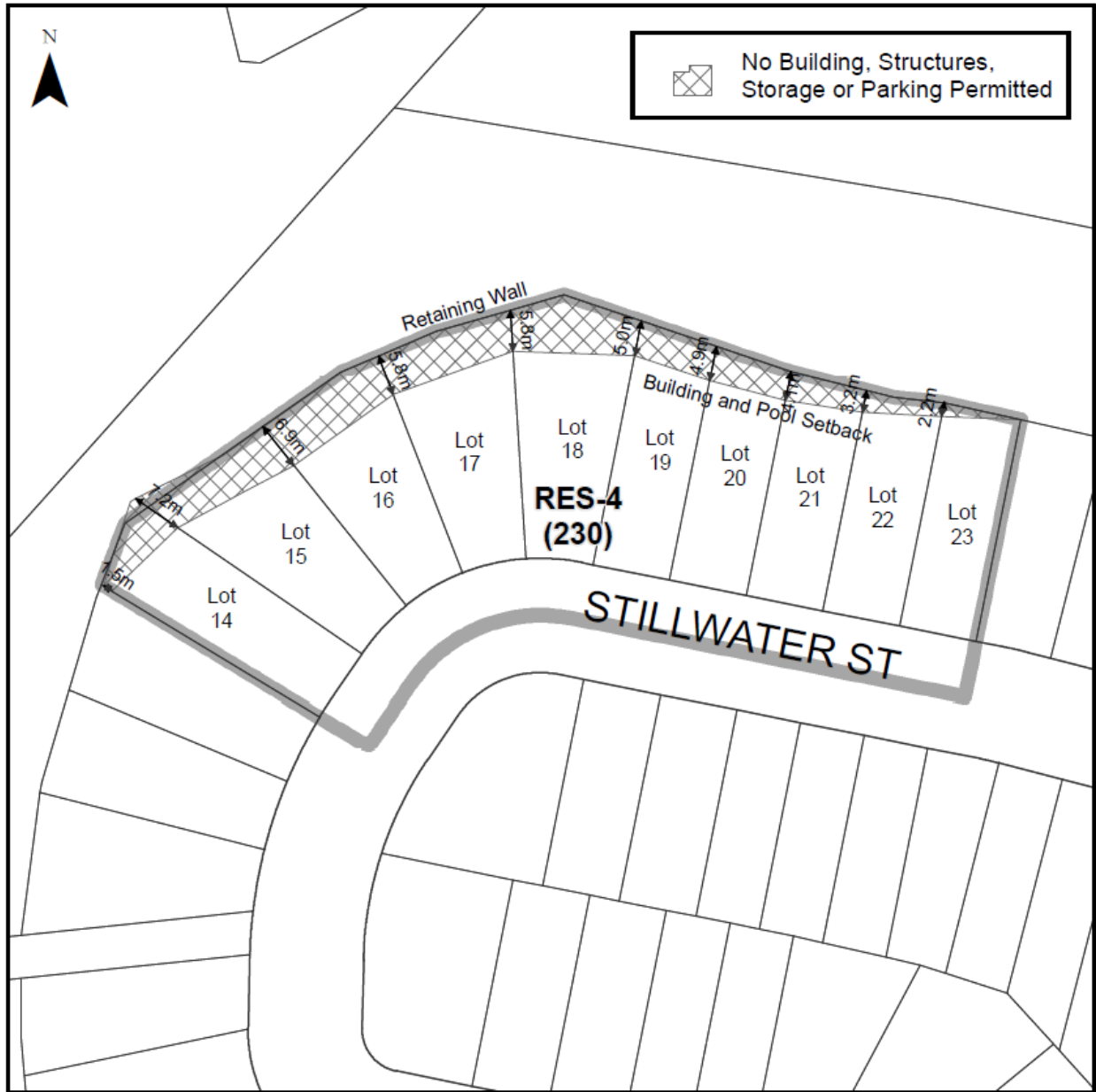

Figure 1